

REMOVAL

1. **DISCONNECT CABLE FROM NEGATIVE BATTERY TERMINAL**

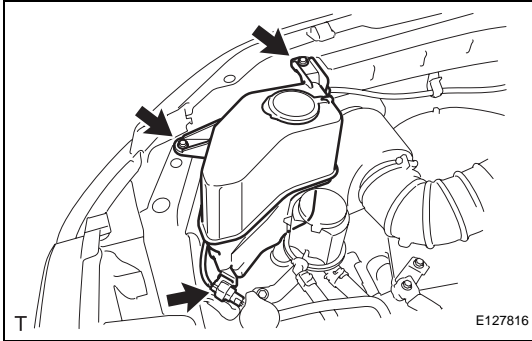

2. **REMOVE WINDSHIELD WASHER JAR ASSEMBLY**
 - (a) Disconnect the connector.
 - (b) Remove the 2 bolts and the windshield washer jar assembly.

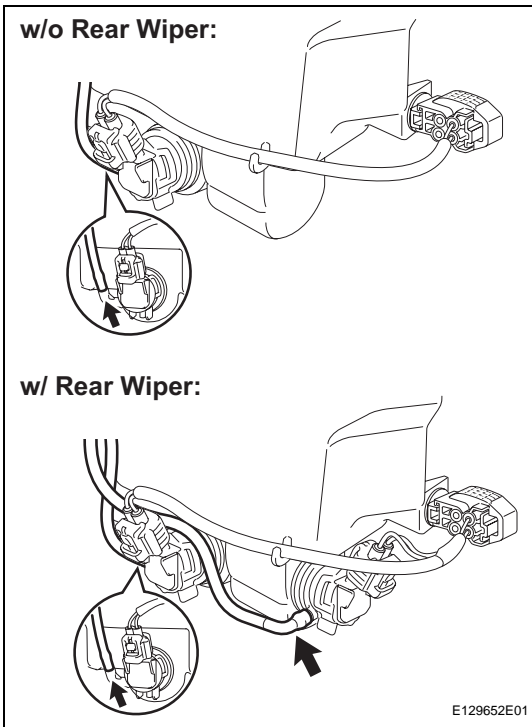

3. **DRAIN WASHER FLUID**

- (a) w/o Rear wiper
 - (1) Disconnect the washer hose from the windshield washer motor and pump, and drain the washer fluid.
- (b) w/ Rear wiper
 - (1) Disconnect the 2 washer hoses from the windshield washer motor and pump, and drain the washer fluid.

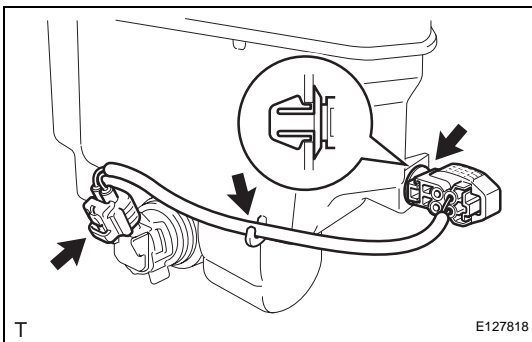

4. **DISCONNECT WASHER WIRING**

- (a) Disconnect the connector and the harness clamps.

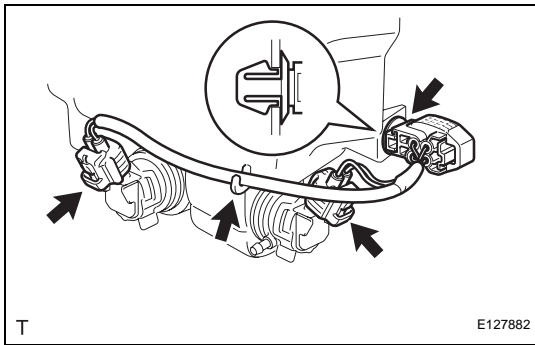

5. DISCONNECT WASHER WIRING (w/ Rear Wiper)

- (a) Disconnect the 2 connectors and the harness clamps.

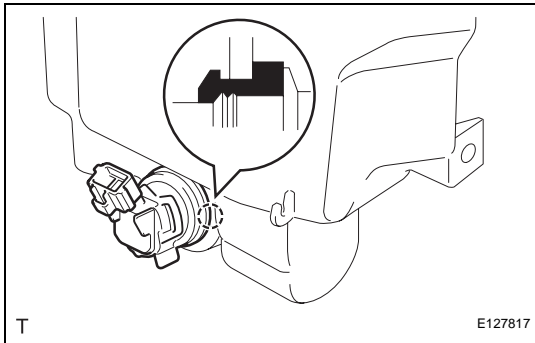

6. REMOVE FRONT WASHER MOTOR AND PUMP ASSEMBLY

- (a) Pull the washer motor and pump out of the packing of the washer jar.

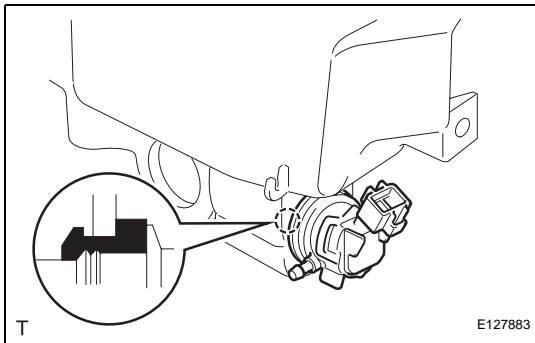

7. REMOVE REAR WASHER MOTOR AND PUMP ASSEMBLY (w/ Rear Wiper)

- (a) Pull the washer motor and pump out of the packing of the washer jar.

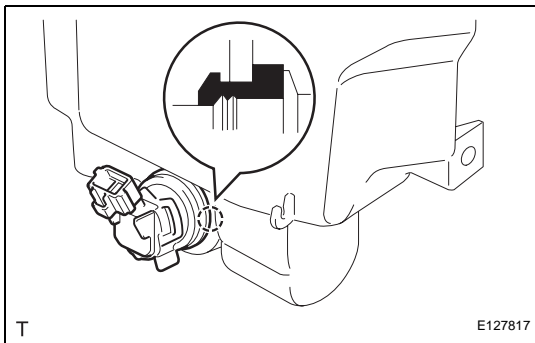

INSTALLATION

1. INSTALL FRONT WASHER MOTOR AND PUMP ASSEMBLY

- (a) Install the windshield washer motor and pump onto the packing of the washer jar.

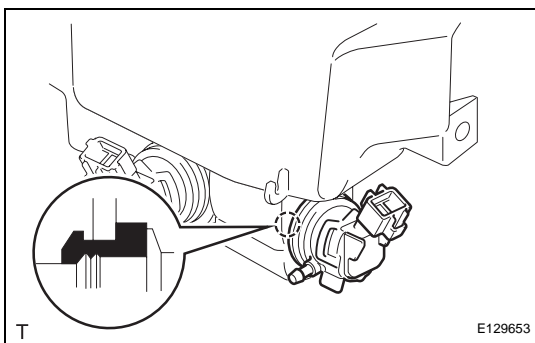

2. INSTALL REAR WASHER MOTOR AND PUMP ASSEMBLY (w/ Rear Wiper)

- (a) Install the windshield washer motor and pump onto the packing of the washer jar.

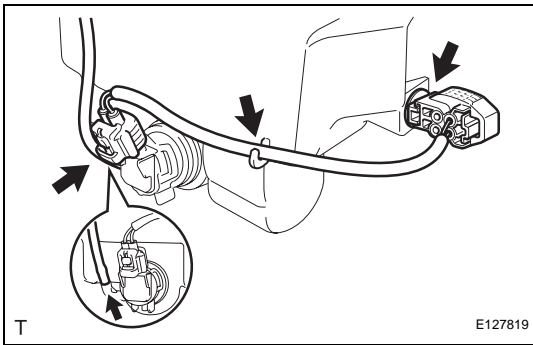

3. CONNECT WASHER WIRING

- (a) Connect the connector and the harness clamps.
- (b) Connect the washer hose.

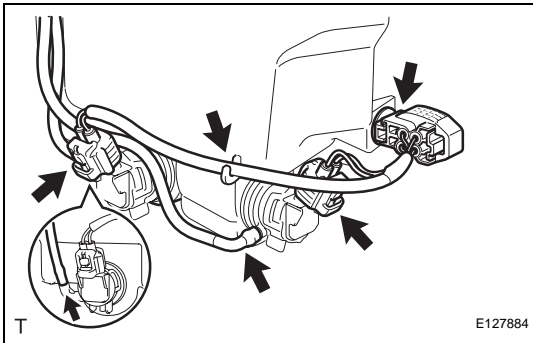

4. CONNECT WASHER WIRING (w/ Rear Wiper)

- (a) Connect the 2 connectors and the harness clamps.
- (b) Connect the 2 washer hoses.

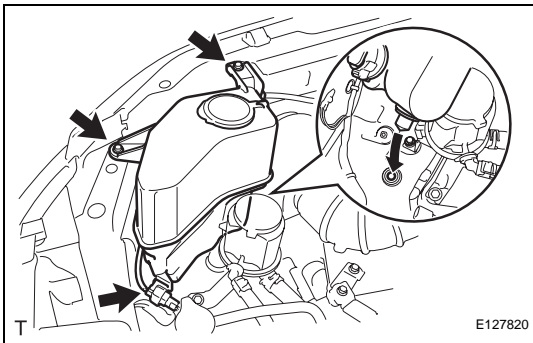

5. INSTALL WINDSHIELD WASHER JAR ASSEMBLY

- (a) Install the windshield washer jar with the 2 bolts.
Torque: 3.5 N*m (36 kgf*cm, 31 in.*lbf)
- (b) Connect the connector.

6. FILL UP WASHER JAR AND PUMP ASSEMBLY WITH WASHER FLUID

- (a) Fill the washer jar with washer fluid.

7. CONNECT CABLE TO NEGATIVE BATTERY TERMINAL

Torque: 3.9 N*m (40 kgf*cm, 35 in.*lbf)

